

精度等级/General Tolerances(mm)		公差带										形位公差	
0	>3	>6	>10	>18	>30	>50	>80	>120	>180	>250	>315	>400	0.1/10
~	~	~	~	~	~	~	~	~	~	~	~	~	±Z
3	6	10	18	30	50	80	120	180	250	315	400	500	±Z
±0.12	±0.18	±0.22	±0.26	±0.31	±0.37	±0.57	±0.80	±1.05	±1.15	±1.60	±2.20	±2.50	±Z

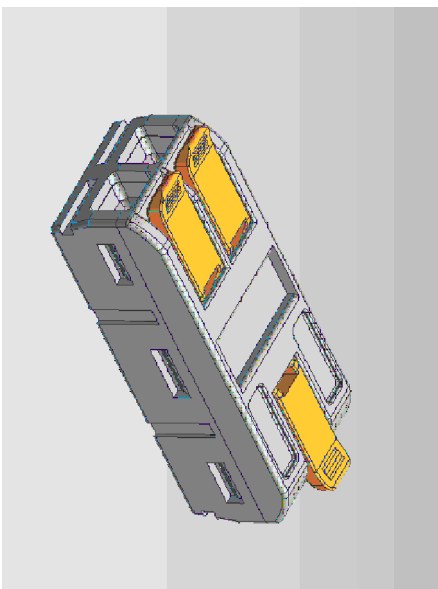
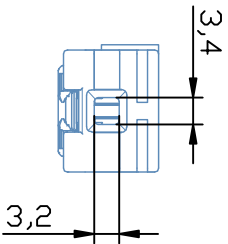
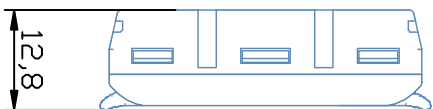
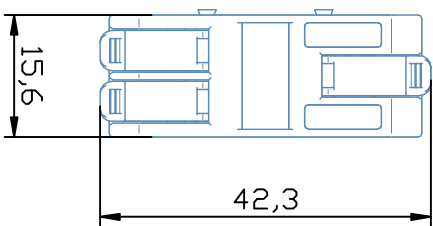
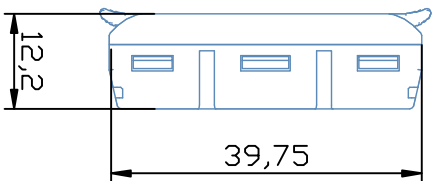
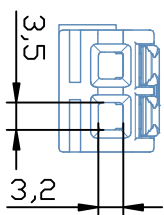

4	排线扣	不锈钢	301
3	导电件	紫铜	
2	Cover	PA66	UL94V-2
1	Housing	PC	UL94V-2

ITEM	NAME OF PART	MATERIAL	NOTES
UL 标准	UL Standard:	B	C
额定电压/电涌/Rated Voltage(V)/Current(A)	450	/	32A
EG 标准/IEC Standard:			
过压类别/Overvoltage Category/污染等级/Pollution Degree	III/2		
额定电压/电涌/Rated Voltage(V)/Current(A)	450/32		
额定脉冲电压(kV)/Rate Impulse Voltage(kV)	8.0		
拉力/pull(N·m/Lb·in)	0.8/8		
线控箱盖(线径mm*线一轴)/出线mm*线一轴)	6-4/4-2.5		
间距/Pitch(mm)/线束范围/Poles	5/N=02~5P		
剥线长度/Stripping length(mm)	10-12		
使用温度范围/Operating Temperature(°C)	-40~+105		
符合RoHS要求/Conform to RoHS	Yes		
标准颜色编号/Standard color number:	/		
PANTONE / RAL	/		

MATERIAL: / SURFACE: /

MAT NO.: /

STATUS: /

APPD: Lon CHH2020.03.24 NAME: **KV6612**

CHKD: Gong YZ2020.03.24

DRT: CENGWZ_2018.10.18 DRAWING NO.: KV6415A

TYPE: CUSTOMER_DRAWING SCALE: 2:1

REV TO 1/1

D

C

B

A

1

2

3

4

5

6

D

C

B

A